

SUNNY ACRES

Located in Gov't Lots 2 & 3, Sec. 3, T. 20 N., R. 23 E.;
SE⁴ SW⁴ & SW⁴ SE⁴, Section 34, T. 21 N., R. 23 E., B.M.,
Lemhi County, Idaho

Correction Instrument # 213360

CERTIFICATE OF OWNER

THIS IS TO CERTIFY THAT THE UNDERSIGNED ARE THE OWNERS IN FEE SIMPLE AND CONTRACT PURCHASERS OF THE FOLLOWING DESCRIBED PROPERTY: A PARCEL OF LAND LOCATED IN U.S. GOVERNMENT LOTS 2 AND 3, SECTION 3, T. 20 N., R. 23 E., AND THE SE⁴ SW⁴ AND THE SW⁴ SE⁴, SECTION 34, T. 21 N., R. 23 E., B.M., LEMHI COUNTY, IDAHO MORE SPECIFICALLY DESCRIBED AS FOLLOWS: COMMENCING AT THE NORTH 1/4 CORNER OF SECTION 3, FROM WHICH THE NORTHEAST CORNER OF SECTION 1 BEARS N 89° 42' 51" E, A DISTANCE OF 421.39 FEET ON A BEARING OF N 89° 42' 51" E TO THE Real Point of Beginning, FROM THIS Real Point of Beginning A DISTANCE OF 357.16 FEET ON A BEARING OF S 0° 22' 51" W
THENCE N 87° 07' W 53.50 FEET; THENCE S 21° 01' 14" E 80.12 FEET; THENCE S 32° 41' 14" W 55.94 FEET; THENCE S 20° 21' 40" E 34.06 FEET; THENCE S 08° 30' 00" W 251.73 FEET; THENCE N 84° 04' W, 110.57 FEET; THENCE S 70° 10' 20" W 59.63 FEET; THENCE S 71° 07' 18" W 228.76 FEET; THENCE N 08° 48' 45" W 103.73 FEET; THENCE N 0° 04' 29" W 251.05 FEET; THENCE N 89° 42' 51" E 446.37 FEET; THENCE N 88° 41' 31" W 116.20 FEET; THENCE S 41° 08' 48" E 255.00 FEET; THENCE S 31° 25' 41" E 1009.72 FEET; THENCE N 39° 26' 28" E 105.85 FEET; THENCE S 43° 35' 17" E 27.48 FEET; THENCE N 47° 20' 00" E 9.97 FEET; THENCE N 50° 56' 30" E 530.34 FEET; THENCE N 47° 20' 00" E 9.97 FEET; THENCE S 0° 22' 51" W 44.98 FEET; TO THE Real Point of Beginning, THE GROSS AREA CONTAINED IN THIS PLATED LAND AS DESCRIBED IS 48.06 ACRES.
THAT IT IS THE INTENTION OF THE UNDERSIGNED TO, AND THEY DO, HEREBY INCLUDE SAID LAND IN THIS PLAT THAT THE UNDERSIGNED DO BY THESE PRESENTS DEDICATE TO THE PUBLIC FOR PUBLIC USE FOREVER ALL STREETS SHOWN ON THIS PLAT.

CERTIFICATE OF SURVEYOR

THIS IS TO CERTIFY THAT I, DAVID J. COUCH, A REGISTERED LAND SURVEYOR IN THE STATE OF IDAHO MADE THE SURVEY OF THE LAND AS DESCRIBED IN THE CERTIFICATE OF OWNER AND DESIGNATED HEREIN AS SUNNY ACRES AND THAT THIS PLAT COMPRISED OF TWO SHEETS IS A TRUE AND CORRECT REPRESENTATION OF SAID SURVEY AS MADE AND STAKED BY ME ON SAID LAND.

David J. Couch
11/17/77

CERTIFICATE OF WAIVER

ELEANOR ALDOUS, DULY ACTING AND QUALIFIED RECORDER OF THE COUNTY OF LEMHI, STATE OF IDAHO, DO HEREBY CERTIFY THAT I EXECUTED THE WITHIN PLAT BY REASON OF THE FAILURE OF THE OWNERS OR PROPRIETORS NAMED TO SO EXECUTE THE PLAT.

Eleanor Aldous
LEMHI COUNTY RECORDER

ACKNOWLEDGEMENT

STATE OF IDAHO } S.S.
COUNTY OF LEMHI }
ON THIS 16th DAY OF April, 1978, BEFORE ME A NOTARY PUBLIC IN AND FOR SAID STATE PERSONALLY APPEARED ELEANOR ALDOUS KNOWN TO ME TO BE THE PERSON WHOSE NAME IS SUBSCRIBED TO THE FOREGOING CERTIFICATE OF WAIVER AND ACKNOWLEDGED TO ME THAT SHE EXECUTED THE SAME.
IN WITNESS WHEREOF I HAVE HEREUNTO SET MY HAND AND AFFIXED MY OFFICIAL SEAL THE DAY AND YEAR IN THIS CERTIFICATE FIRST ABOVE WRITTEN.

Laura E. Kane
NOTARY PUBLIC FOR THE STATE OF IDAHO

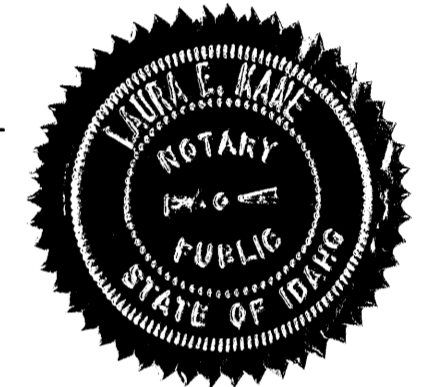

ACKNOWLEDGEMENT

STATE OF IDAHO } S.S.
COUNTY OF LEMHI }
ON THIS 16th DAY OF November, 1977, BEFORE ME A NOTARY PUBLIC IN AND FOR SAID STATE PERSONALLY APPEARED DAVID J. COUCH KNOWN TO ME TO BE THE PERSON WHOSE NAME IS SUBSCRIBED TO THE FOREGOING CERTIFICATE OF SURVEYOR, AND ACKNOWLEDGED TO ME THAT HE EXECUTED THE SAME.
IN WITNESS WHEREOF, I HAVE HEREUNTO SET MY HAND AND AFFIXED MY OFFICIAL SEAL THE DAY AND YEAR IN THIS CERTIFICATE FIRST ABOVE WRITTEN.

Marvin G. Brown
NOTARY PUBLIC FOR THE STATE OF IDAHO



Val E. Franklin
VAL E. FRANKLIN

Arlene L. Franklin
ARLENE L. FRANKLIN

RICHARD W. BARTELL, JR.
DIANE BARTELL

CLOIS FITZHUGH
BILL PIERCE

ACKNOWLEDGEMENT

STATE OF IDAHO } S.S.
COUNTY OF LEMHI }
ON THIS 16th DAY OF November, 1977, BEFORE ME A NOTARY PUBLIC IN AND FOR SAID STATE, PERSONALLY APPEARED VAL E. FRANKLIN AND ARLENE L. FRANKLIN AND ACKNOWLEDGED TO ME THAT THEY EXECUTED THE SAME.
IN WITNESS WHEREOF I HAVE HEREUNTO SET MY HAND AND AFFIXED MY OFFICIAL SEAL THE DAY AND YEAR IN THIS CERTIFICATE FIRST ABOVE WRITTEN.

Marvin G. Brown
NOTARY PUBLIC FOR THE STATE OF IDAHO



COUNTY COMMISSIONERS ACCEPTANCE

THE FOREGOING PLAT WAS DULY ACCEPTED AND APPROVED AND MAINTENANCE OF ALL PUBLIC STREETS WAS ACCEPTED BY THE BOARD OF COUNTY COMMISSIONERS OF THE COUNTY OF LEMHI, IDAHO ON THIS 27th DAY OF February, 1978.

Eleanor Aldous
ATTEST: CLERK

Jack Wergand
CHAIRMAN

COUNTY RECORDER'S CERTIFICATE

STATE OF IDAHO } S.S.
COUNTY OF LEMHI }
THIS IS TO CERTIFY THAT THE FOREGOING PLAT WAS FILED IN THE OFFICE OF THE RECORDER OF LEMHI COUNTY, IDAHO ON THIS 16th DAY OF April, 1978 AT 9:32 A.M. AND DULY RECORDED IN PLAT BOOK 5 AT PAGE 7.

Eleanor Aldous
EX-OFFICIO RECORDER

SANITARY RESTRICTIONS

EACH LOT IN THIS SUBDIVISION MUST BE CONNECTED TO AN INDIVIDUAL WATER SYSTEM AND A SEPTIC TANK SYSTEM CONSTRUCTED TO IDAHO DEPARTMENT OF HEALTH STANDARDS. IDAHO DEPARTMENT OF ENVIRONMENTAL PROTECTION AND HEALTH.

BY: *James F. Werry* DATE Nov. 16, 1977

TITLE: E.G.S

COUNTY PLANNING AND ZONING COMMISSION'S ACCEPTANCE

THIS PLAT WAS ACCEPTED AND APPROVED BY THE COUNTY PLANNING AND ZONING COMMISSION OF LEMHI COUNTY, IDAHO.

Michael J. Querscher
CHAIRMAN

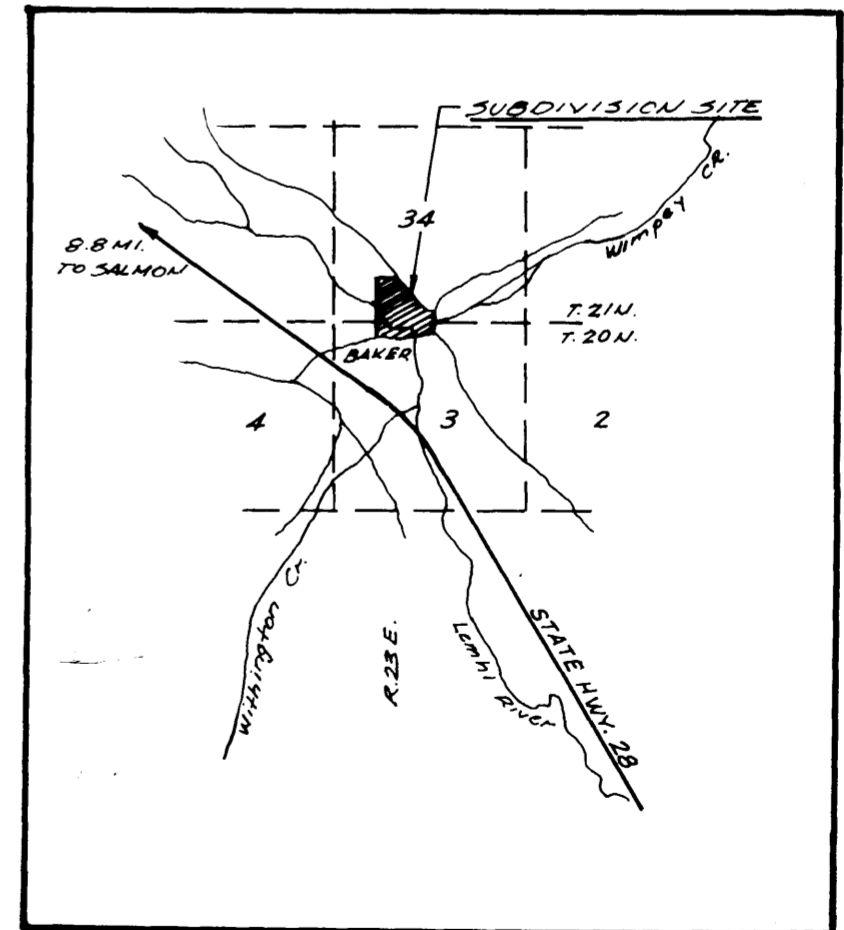

VICINITY MAP